



**EC Collaborative Project SILER:
Seismic-Initiated events risk mitigation
in LEad-cooled Reactors**

THEME: Fission 2011-2.3.1: R&D activities in support of the
implementation of the Strategic Research Agenda of SNE-TP

Grant Agreement 295485

October 1st, 2011 - September 30th, 2014



How to isolate a NPP - interface components: fail safe system

Verona - 25 May 2012

Alberto Dusi

Numeria Consulting srl – Cremona, Italia

DEVICES FOR BASE ISOLATION OF NPP

HDRB

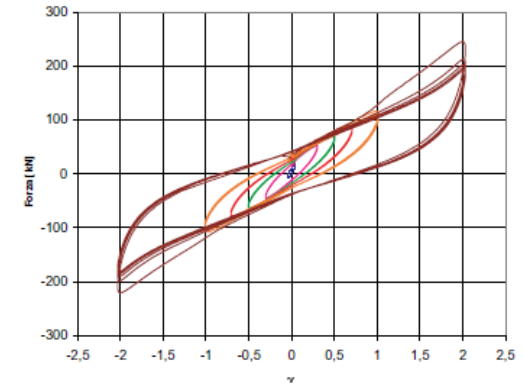

LRB

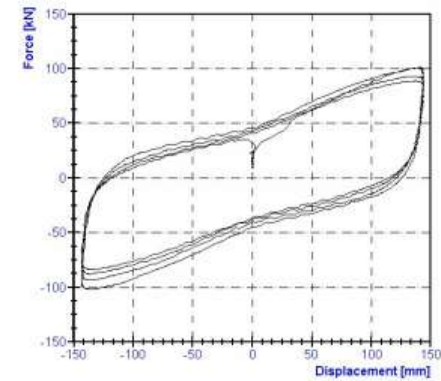
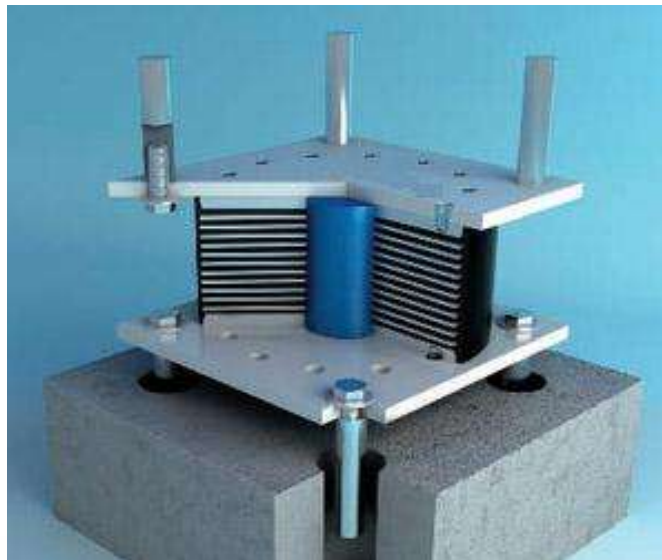

ELSY NPP

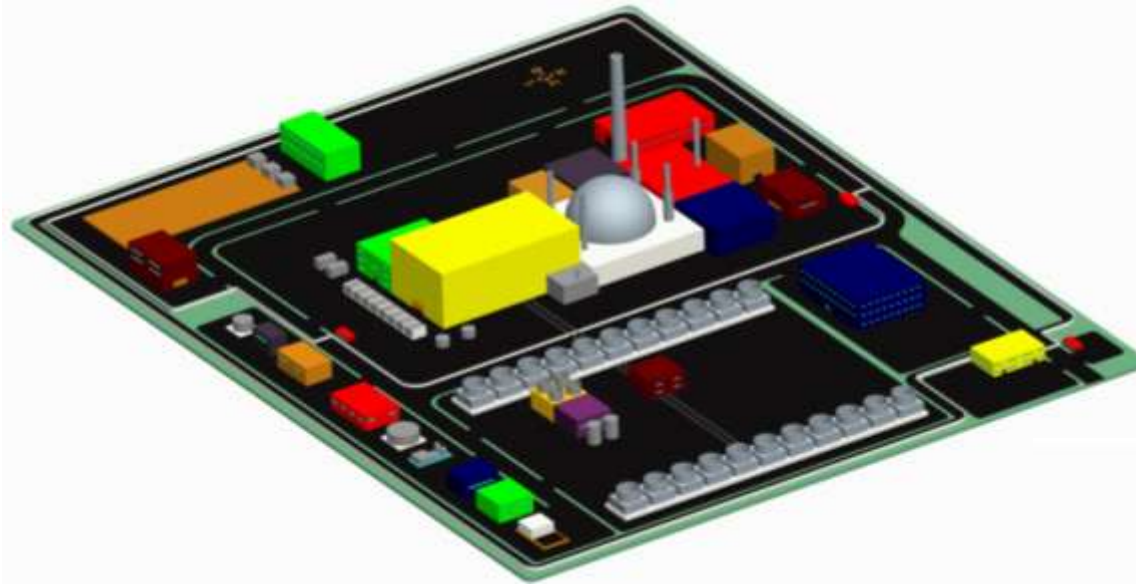

Sketch of the ELSY plan layout

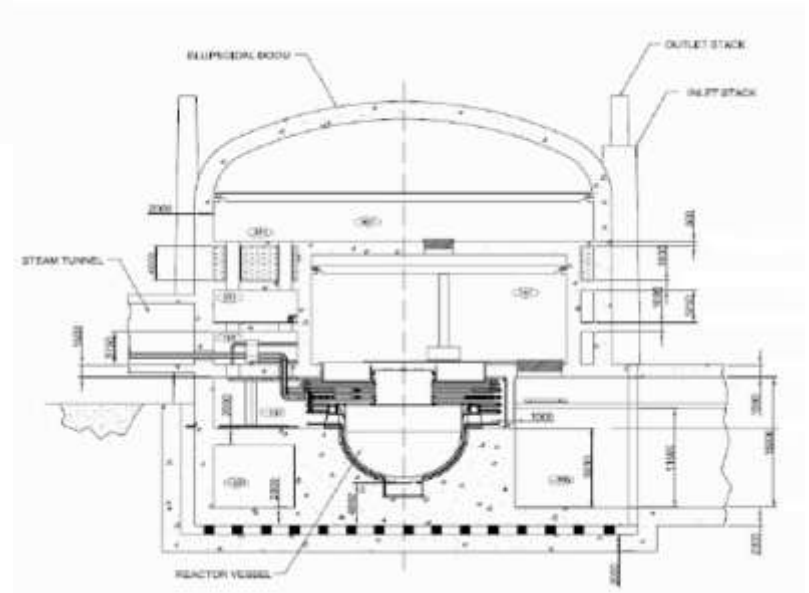

Section of the reactor building with seismic isolation

ELSY NPP

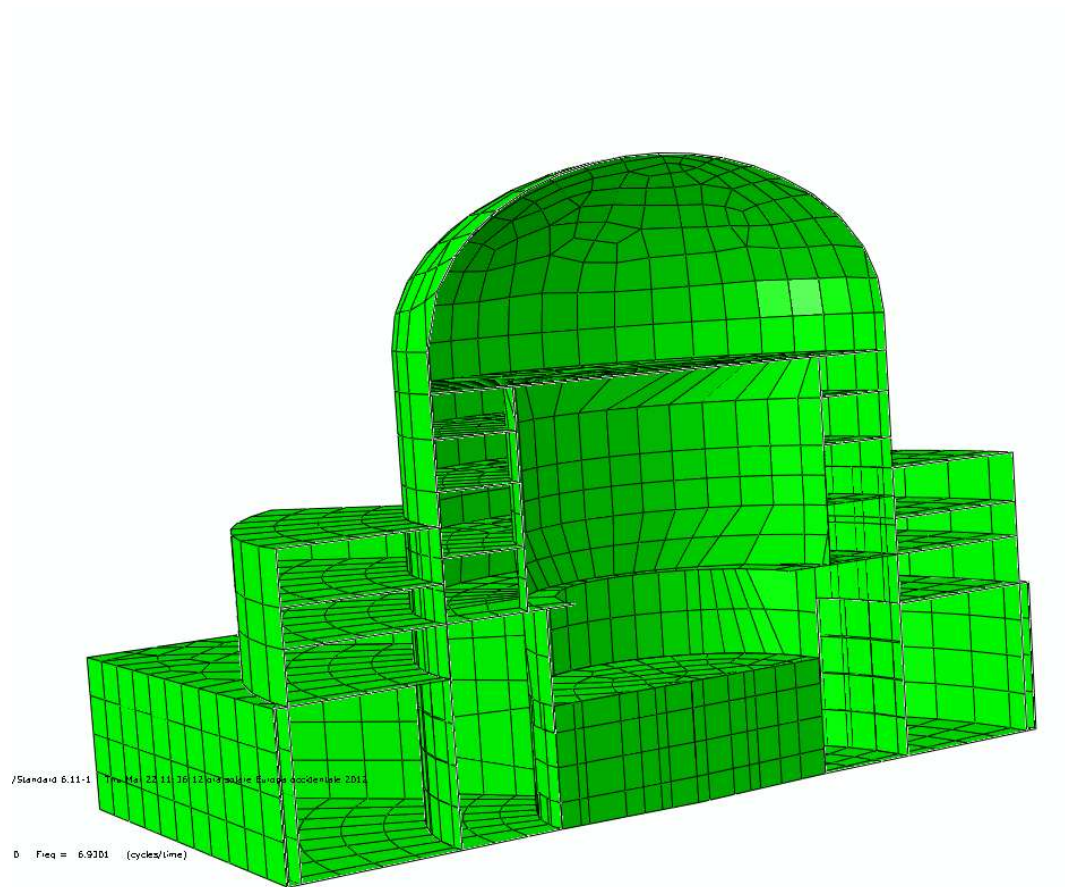

FEM

MYRRHA NPP



Sketch of the MYRRHA plan layout

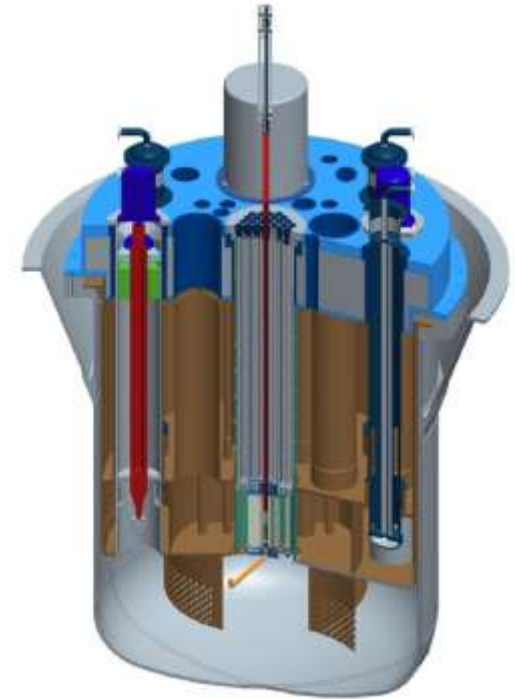

Tank-proton beam coupling

MYRRHA NPP

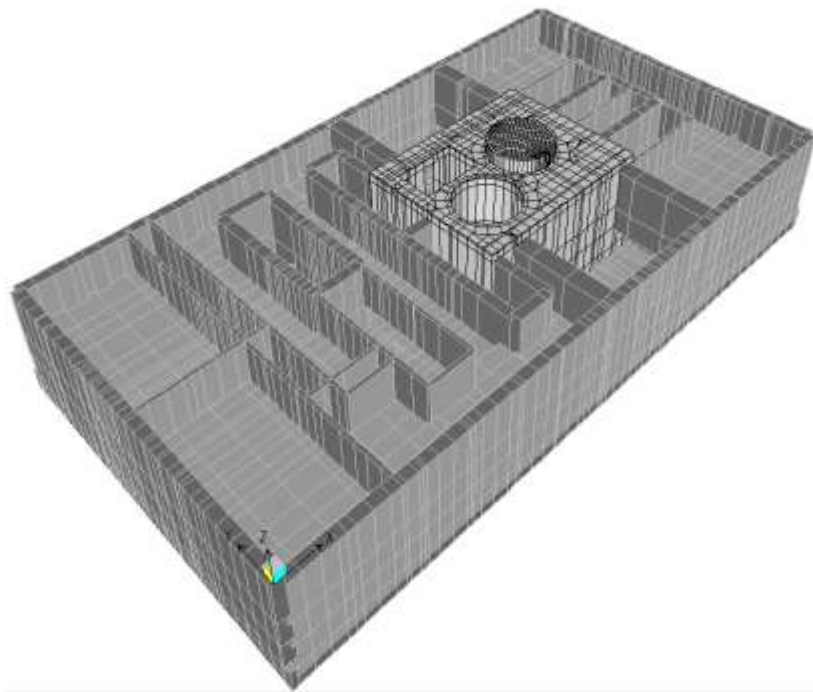

FEM – plan view

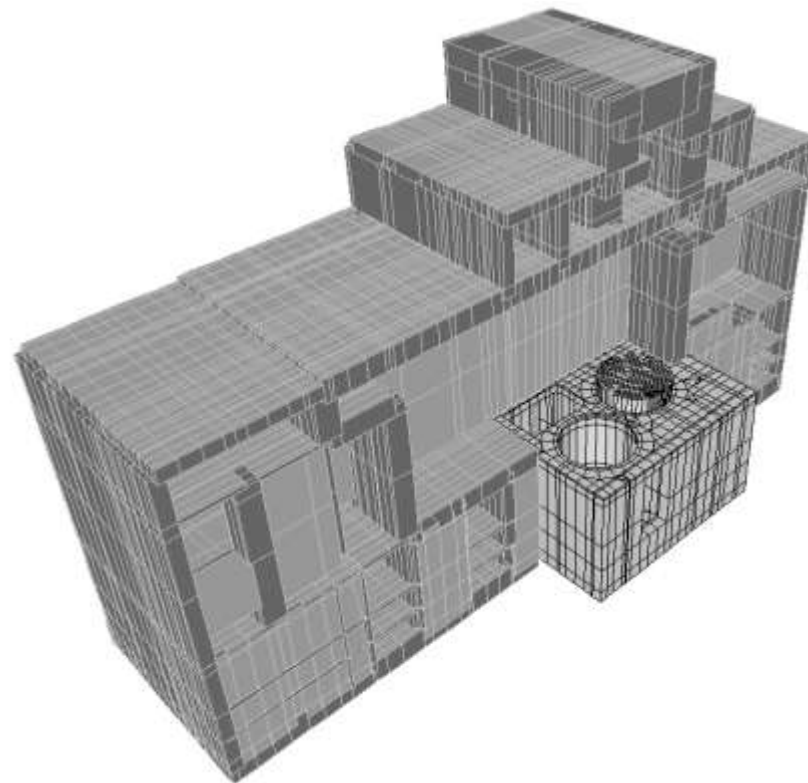

FEM – section

SEISMIC INPUT

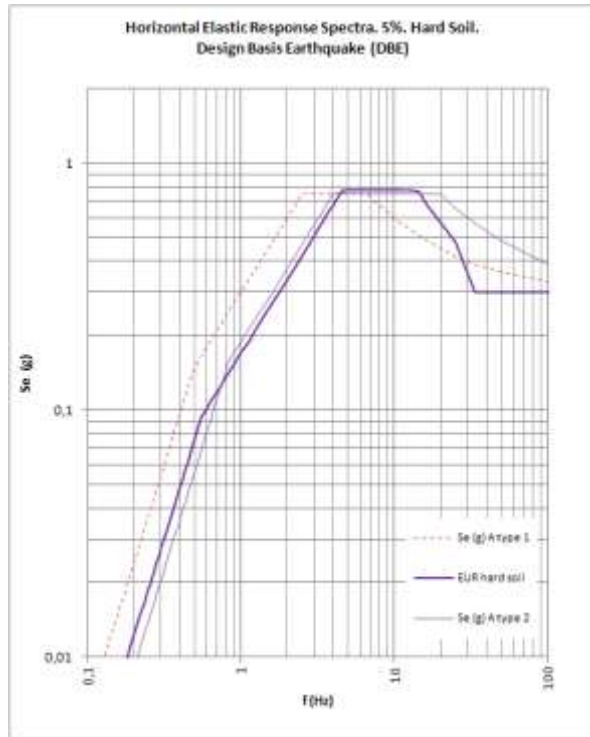

The isolators (HDRB or LRB) are designed for shear deformations corresponding to the design conditions (**DBE**)

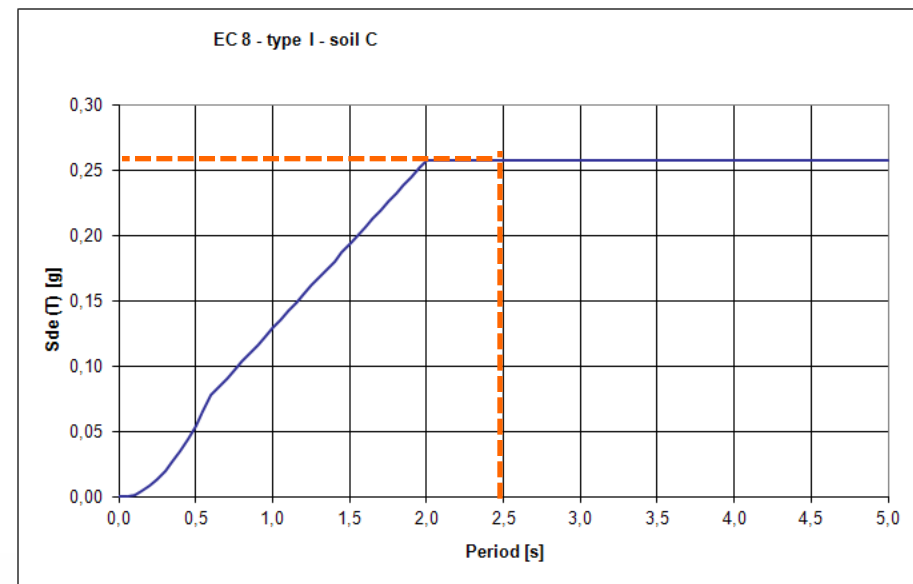
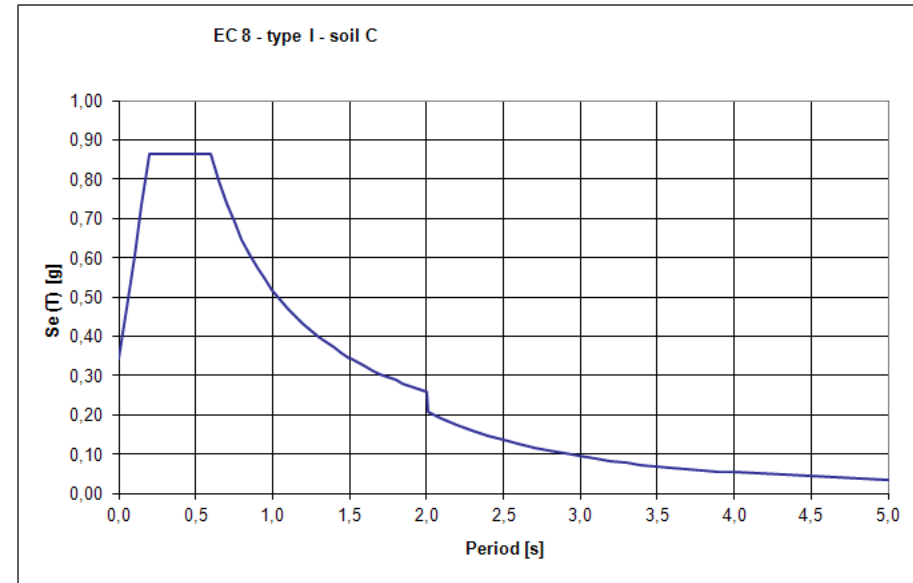

FAIL SAFE SYSTEM

In case of **beyond design earthquakes**, the isolators shall never lose the capability of supporting the vertical load.

Thus, the adoption of an horizontal fail safe system is needed to limit the isolator deformation for extreme events.

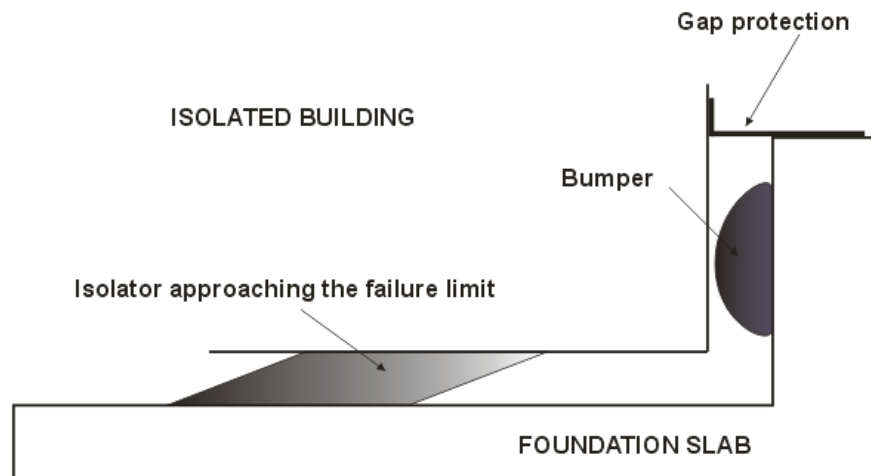

FAIL SAFE SYSTEM – some preliminary conceptual design options

Goal: develop a unit capable of dissipating the kinetic energy with controlled displacement and an almost constant force

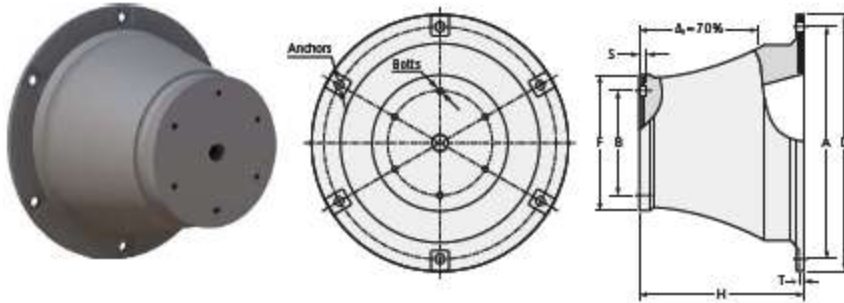

Fender type



Modified elastic device
(like those used in bridges)



Stop unit

+



Dampers (?)

FAIL SAFE SYSTEM – pounding modeling: simplified approach

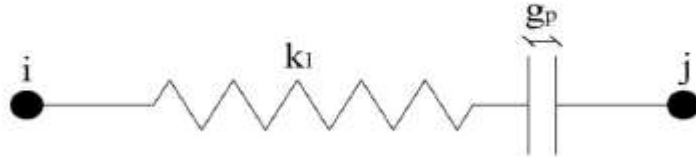

“Gap” model

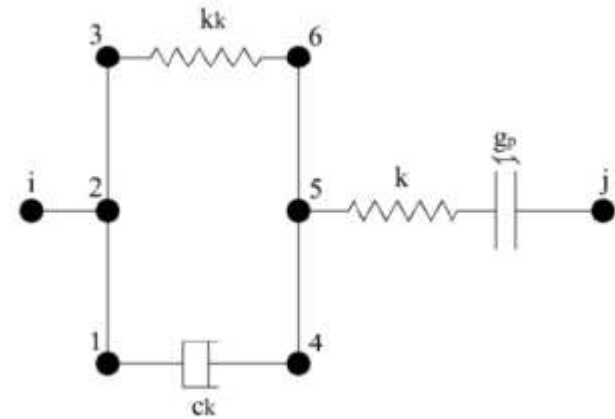

“Kelvin-Voigt” model

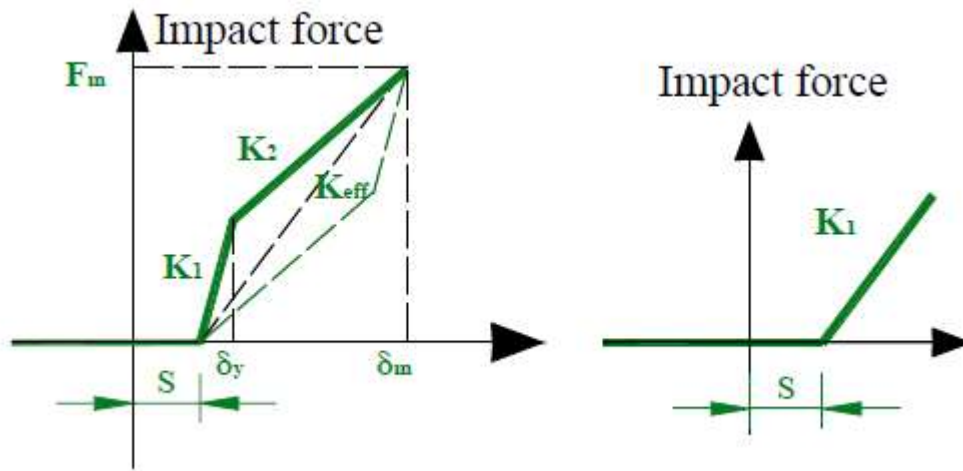

Truss contact element for pounding simulation

THANK YOU

Alberto Dusi

Numeria Consulting srl, Cremona

dusi@numeria-eng.it

www.numeria-eng.it